

### Step 1

Unlock the latches and pull off ties.

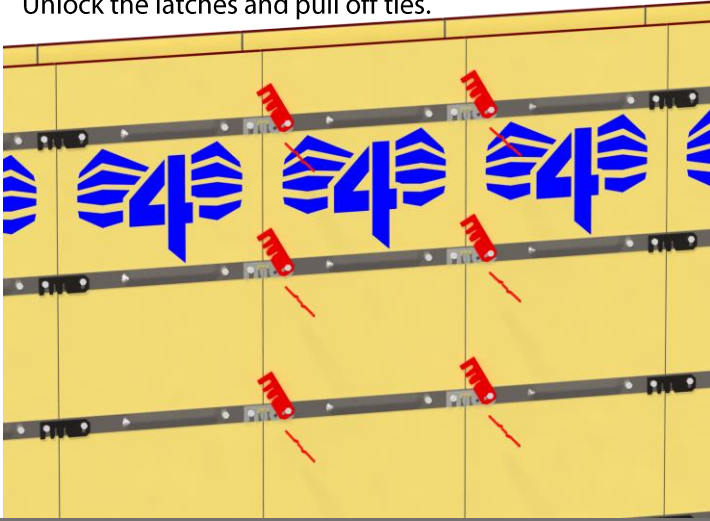

### Step 2

Slide down base into forms.

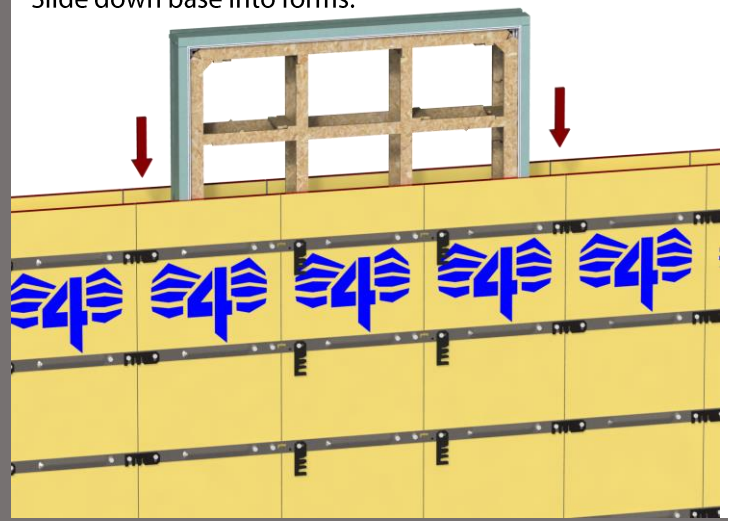

### Step 3

Place at desired height and level.

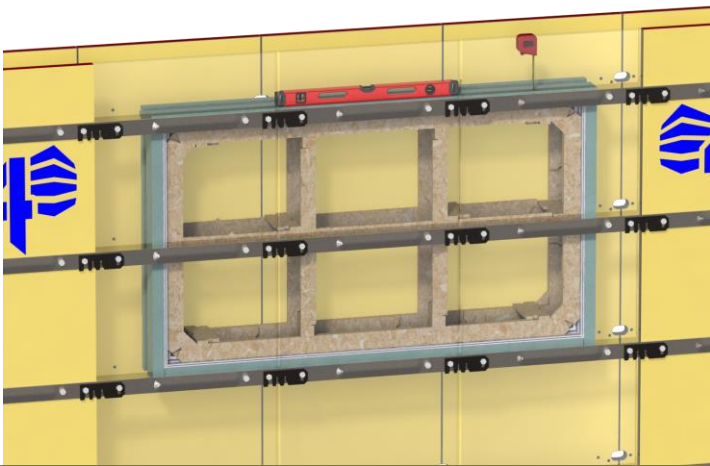

### Step 4

Screw or nail all around in the wooden frame on both sides. Screw/nail on wooden brace **PERIMETER** only.

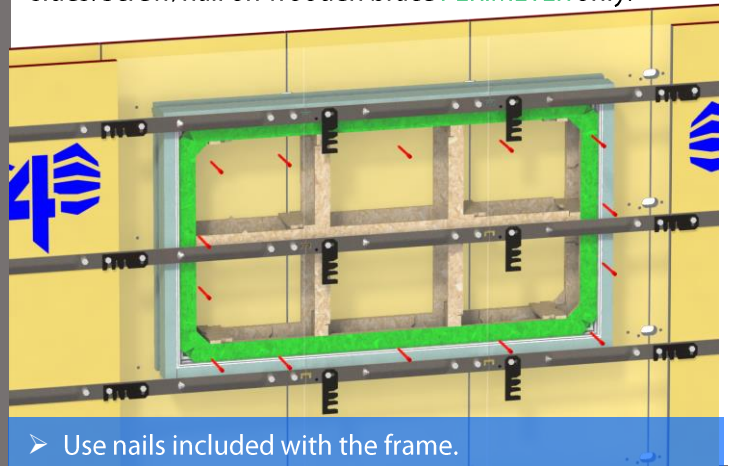

➤ Use nails included with the frame.

### Step 5

REINSTALL ties. Lock the latches.

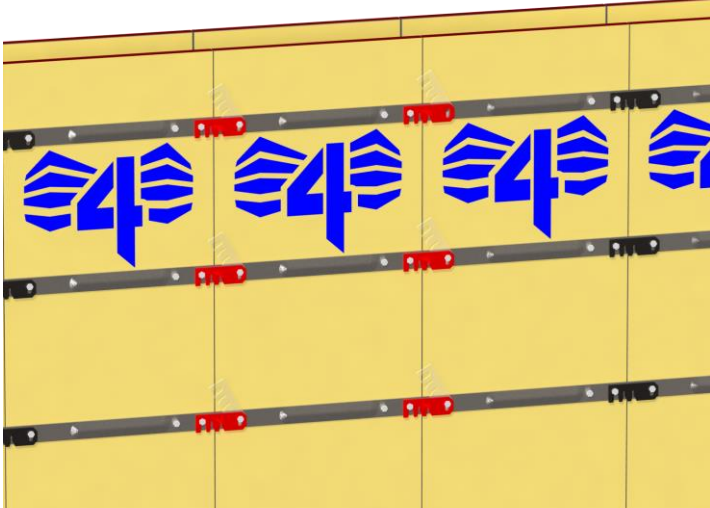

### Step 6

Pour the concrete according to the recommended method.

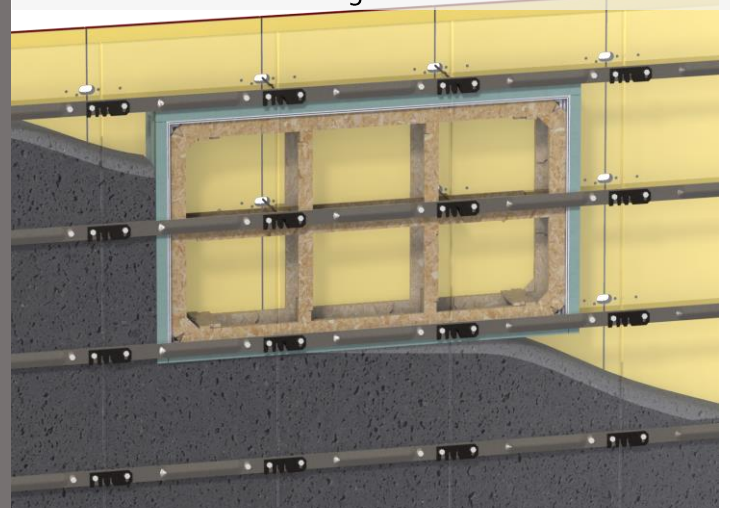

# Pour-in-Place Window

2<sup>nd</sup> method (optional for big sized windows)

## Step 1

Unlock the latches, pull off ties and remove the inside panels where the window will be fixed.



## Step 2

Place the base at the required height and level it.

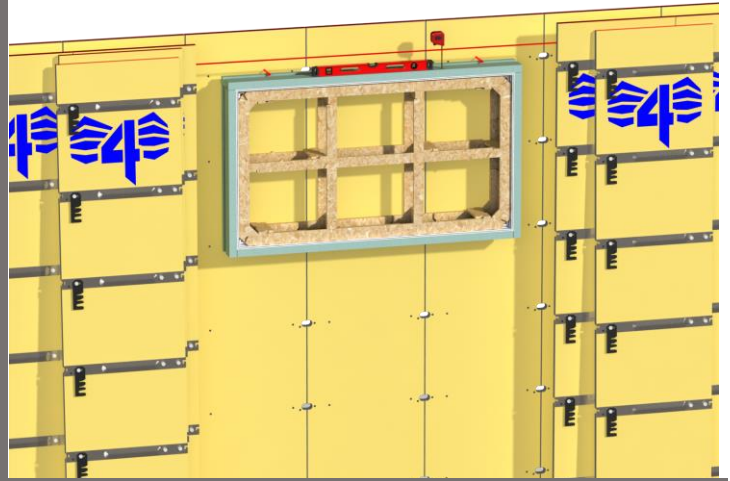

## Step 3

Carefully remove the protective film. Nail through the inside **perimeter** of the wooden brace. Stick back the film.



➤ Use nails included with the frame.

## Step 4

Reinstall formwork panels, reinsert the ties and lock the latches.

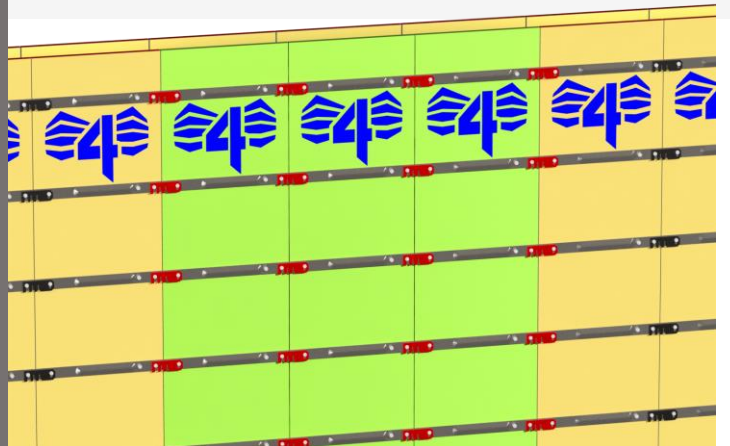

## Step 5

Screw or nail through formwork in the bracing. Make sure to find out exactly where it's located to avoid any damage to the base.

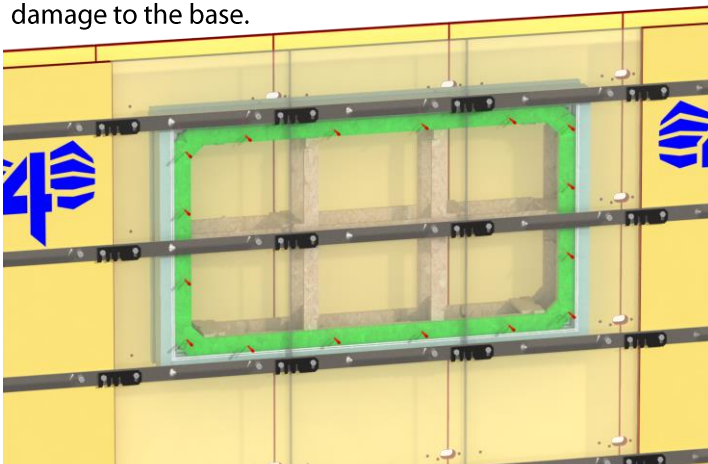

## Step 6

Pour the concrete according to the recommended method.

